

PARASITOLOGY CENTER INC.

Blood Smear Test Instructions

PART 1: BEFORE YOU START TAKING THE TEST:

To maximize test accuracy, don't take antibiotics, anti-parasitics drugs or herbal anti-parasitics for 2 weeks taking blood samples. Do not go off any medication without your physician's approval. Please email info@parasitetesting.com if you have any questions about this process.

1. Creating the thin film blood smear

- All slides should be handled by their edges and kept completely clean.
- Designate one of the clear slides as your "smearing slide". The other two slides will be "sample slides". Place the 2 sample slides on a flat and clean surface.

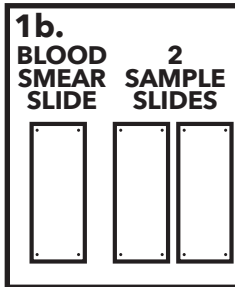
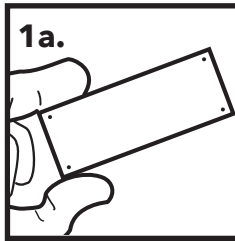

PART 2: HOW TO TAKE THE TEST

Read the entire directions before you begin using the test kit. The test is a bit tricky and I want you to do it correctly to maximize the accuracy of the test results.

1. How to Clean your finger:

- First, you should clean the fingertip you intend to prick with 70% alcohol wipes. This cleaning can help prevent infection.

2. How to Get A Good Drop of Blood on the slide:

- Twist off the bottom of the lancet.
- Press the lancet against your finger, and then press down the top of the lancet.

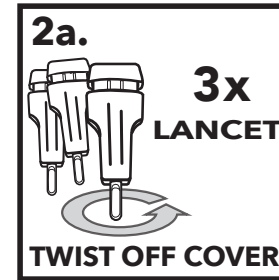

- The first blood that comes out is not suitable for analysis. Wipe it off with an alcohol wipe.

- Let a drop of blood form on the bottom of your finger. Gravity helps the blood flow more easily. So please hold the finger puncture towards the ground to get a drop faster. You may also squeeze **very gently** to help increase the blood flow. Once you have a drop of blood on your finger, **transfer it to the slide quickly** so that it does not coagulate.

- Let a drop of blood form on the bottom of your finger.

- Transfer that drop of blood to one of your "sample slides", about 1/2 an inch from the edge of the slide.

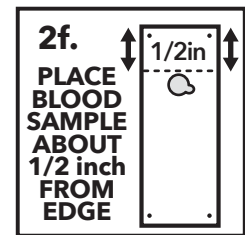
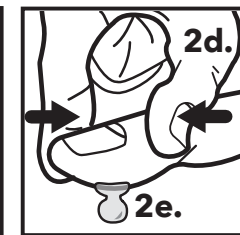

PARASITOLOGY CENTER INC.

Blood Smear Test Instructions

3. Creating the thin film blood smear

a. Place a drop of blood created in step 2 on a slide about half an inch from the left edge of the slide. Take your designated "smearing slide" and place it on the surface of the first slide at about a 30° to 45° angle, as indicated in **figure 3b**.

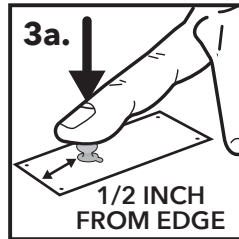

b. *With the slide at a 30° to 45° degree angle, pull the slide to the right (towards the furthest edge).* As you move to the right, **press down lightly** so you don't crush the blood cells or crush evidence of parasites.

For a video of how to create the blood slide scan the QR code here



3b. HOLD THE BLOOD SMEAR SLIDE AT 45° ANGLE AGAINST SAMPLE SLIDE

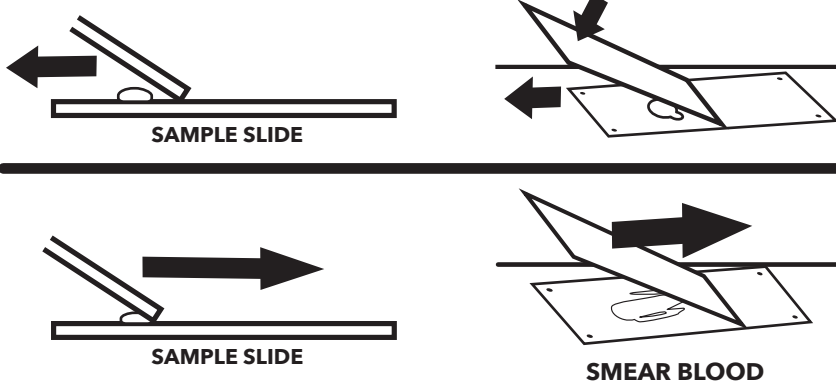

4. Drying the slides

a. Place the slides on a flat and horizontal surface to allow them to dry thoroughly. Don't let the slides touch each other. Protect the slides from people, animals, flies and dirt. **Depending on the local humidity, drying can take anywhere from 15 minutes to 60+ minutes.**

5. Packing the slides for transport

a. Once the slides are completely dry, load them into the slide holder. Make sure that the slides are packed in the slide case correctly. **When in the slide holder, the slides should not touch each other or they will be ruined.**

PART 3: RETURN SHIPPING INSTRUCTIONS

Fill out the requisition form completely. Samples not accompanied by a requisition form will **NOT be processed, and test results will be delayed.**

For shipping, Shipment of samples is the responsibility of the patient. Use a courier of your choice (USPS, UPS, FedEx, etc.)

Ship to: PCI 11445 E. Via Linda #2-419, Scottsdale, AZ 85259.

This address goes to our box which is located inside the UPS store. We do pickups every morning

